

# KIDS LAMPS

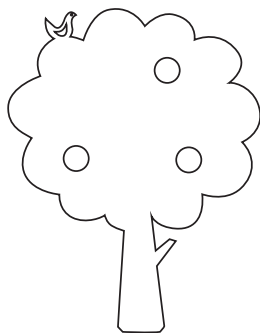

TREE LAMP



HOUSE LAMP

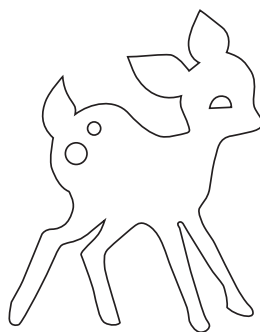

MY DEER LAMP

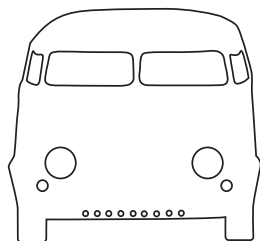

CAR LAMP



CLOUD LAMP

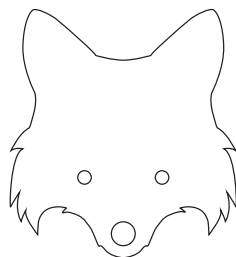

FOX LAMP

INFORMATION

England (UK) ..... 4  
Denmark (DK) ..... 5  
Sweden (SE) ..... 6  
Norway (NO) ..... 7  
Iceland (IS) ..... 8  
Finland (FI) ..... 9  
Germany (DE) ..... 10  
The Netherlands (NL) ..... 11  
France (FR) ..... 12  
Spain (ES) ..... 13  
Portugal (PT) ..... 14  
Italy (IT) ..... 15  
Poland (PL) ..... 16  
Hungary (HU) ..... 17  
Czech Republic (CZ) ..... 18  
Slovenia (SI) ..... 19  
Estonia (EE) ..... 20  
Latvia (LV) ..... 21  
Lithuania (LT) ..... 22  
Greece (EL) ..... 23

## INFORMATION - UK

The lamp is used exclusively for lighting mounted on the wall, and is to be installed in accordance with the national installation regulations. Any other use is regarded as not according to instructions. Verify that product ratings meet supply ratings before installing the luminaire. We recommend to attach the wire to the wall, as loose wires may cause a strangulation risk to babies and small children.

## DATA

### Wood

Plywood with front in smoked oak veneer or paint

### Plastic cover

Opal polycarbonat (opal Lexan 940)

### Connection

AC 220-240V~50/60 Hz with LED driver

### IP code

IP20

### Light sources

LED only  
Wattage max. 2 x 3W  
Voltage: 12V  
Lamp socket: G4

### LED driver

AC 220-240V~50/60 Hz  
DC 12V, 12W power:  
1 Amp.

### Driver Stand by consumption

Power: 0,0W

## LIGHT SOURCES

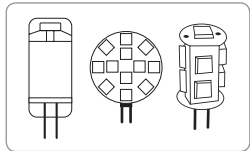

LED examples

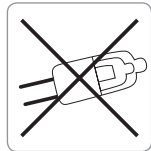

No halogen light source



Non dimmable

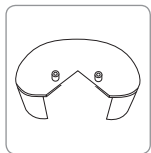

Disassemble plastic cover when replacing light sources

## MOUNTING INSTRUCTIONS

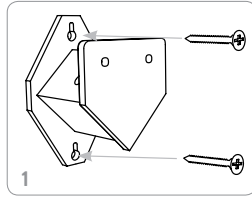

1. Place the lamp socket on the wall and secure it with two of the included screws

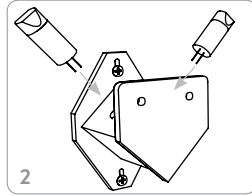

2. Put in two LED light sources

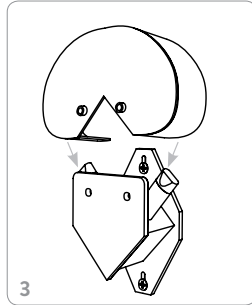

3. Take the plastic cover and place it above the LED light sources

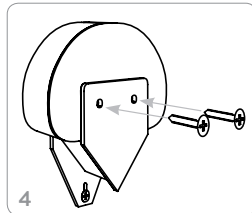

4. Fasten the plastic cover to the lamp socket with two of the included screws

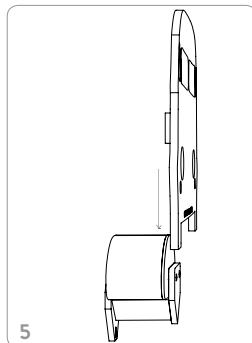

5. Take the front of the lamp and slide it down on the front area on the lamp socket. Connect the LED driver to the lamp and then to the supply

## INFORMATION - DK

Lampen er udelukkende brugt til belysning monteret på væggen, og skal installeres i overensstemmelse med de nationale installations-regulativer. Enhver anden brug betragtes som værende ikke i henhold til instruktionerne. Tjek at produktets strømspænding tilsvarende strømforsyningens, inden lampen tilsluttes. Vi anbefaler at fastgøre ledningen til væggen, da løse ledninger på lamper kan udgøre en risiko for kvælning af babyer og mindre børn.

## DATA

### Træ

Krydsfiner med røget egefront eller malet front

### Plastikafdækning

Opal polycarbonat (opal Lexan 940)

### Tilslutning

AC 220-240V~50/60 Hz med LED-driver

### IP kapslingsklasse

IP20

### Lyskilder

Kun LED  
Watt max. 2 x 3W  
Spænding: 12V  
Lampefatning: G4

### LED driver

AC 220-240V~50/60 Hz  
DC 12V, 12W power:  
1 Amp.

### Forbrug

Power: 0,0W

## LYSKILDER

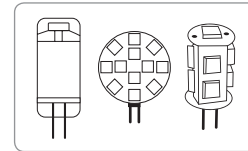

LED-eksempler

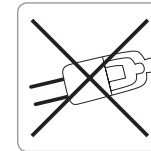

Brug ikke halogenpærer

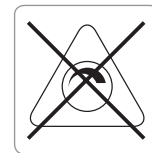

Ikke dæmpbar

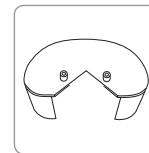

Ved udskiftning af lyskilder demonteres plastikafdækning

## MONTERINGSVEJLEDNING

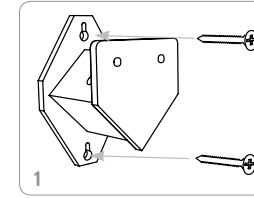

1. Placer lampefatningen det ønskede sted på væggen og skru den fast med to af de medfølgende skruer

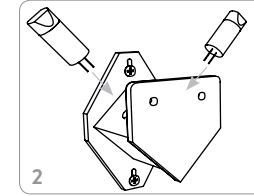

2. Indsæt to LED-lyskilder

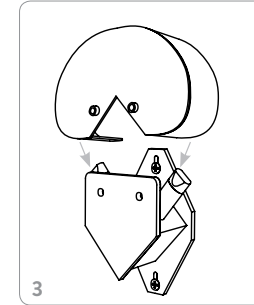

3. Tag plastikafdækningen og placer den over LED-lyskilderne

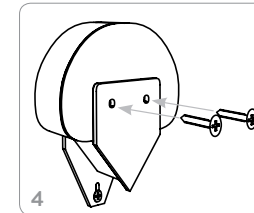

4. Fastgør plastikafdækningen til lampefatningen med to af de medfølgende skruer

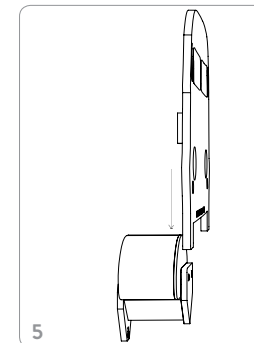

5. Tag lampefronten og kør den ned over frontstykket på lampefatningen. Tilslut LED-transformeren til lampen og derefter til strømforsyningen

## INFORMATION - SE

Denna lampa är uteslutande avsedd för användning som ljuskälla när den är monterad på en vägg. Den ska monteras i enlighet med nationella regler för installation. All annan användning bryter mot instruktionerna. Försäkra dig om att spänningen som anges på produkten motsvarar spänningen i ellutaget innan lampan monteras. Vi rekommenderar att sladden fästs till väggen då lösa sladdar kan utgöra en strykningsfara för små barn.

## DATA

### Trä

Plywood med yta i rök ek eller färg

### Plasthölje

Opal polycarbonat (opal Lexan 940)

### Anslutning

AC 220-240V-50/60 Hz med LED-drivenhet

### IP kod

IP20

### Ljuskällor

Bara LED  
Max 2 x 3W  
Spänning: 12V  
Lampsockel: G4

### LED-drivenhet

AC 220-240V-50/60 Hz  
DC 12V, 12W effekt:  
1 Amp.

### Standbyförbrukning för drivenhet:

Effekt: 0,0W

## LJUSKÄLLOR

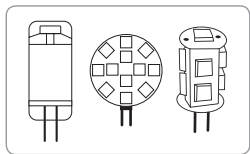

LED-eksempel

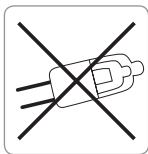

Använd inte halogenlampor

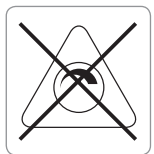

Ej dämpbar

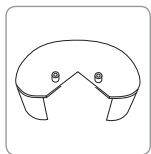

Avlägsna plasthöljet när glödlampan byts ut

## MONTERINGSINSTRUKTIONER

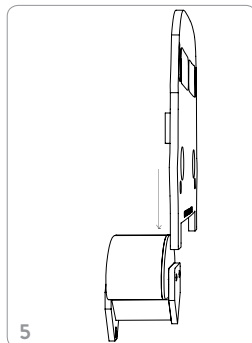
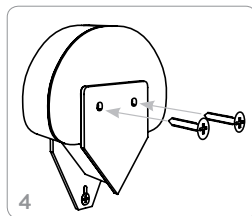
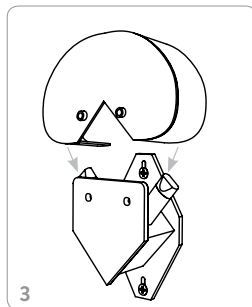
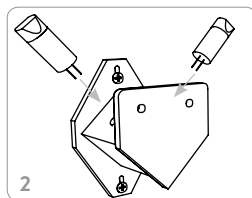
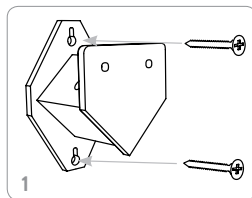

1. Sätt lampsockeln på väggen och fäst den med två av de skruvar som följer med

2. Sätt i två LED-lampor

3. Placera plasthöljet över LED-lamporna

4. Fäst plasthöljet till sockeln med två av de skruvar som följer med

5. För ned lampans framsida över lampsockeln. Anslut LED-drivenheten till lampan och därefter till eluttaget

## INFORMATION - NO

Lampen skal utelukkende brukes til belysning montert på veggen, og skal installeres i overensstemmelse med nasjonale installasjonsregler. All annen bruk regnes som brudd på instruksjonene. Kontroller at produktets spenning tilsvarer strømforsyningens spenning før du installerer lampen. Vi anbefaler at ledningen settes fast i veggen, da løse ledninger på lamper kan utgjøre en kvelningsrisiko for babyer og små barn.

## DATA

### Tre

Kryssfiner med front i røkt eikefiner eller malt front

### Plastdekselet

Opalfarget polykarbonat (opal Lexan 940)

### Tilkobling

220-240VAC-50/60 Hz med LED-driver

### IP-klasse

IP20

### Lyskilder

Kun LED  
Wattstyrke maks. 2 x 3W  
Spenning: 12V  
Lampeholder: G4

### LED driver

220-240VAC-50/60Hz  
DC 12V, 12W  
strømstyrke:  
1 Ampere

### Forbruk i stand-by

Power: 0,0W

## LYSKILDER

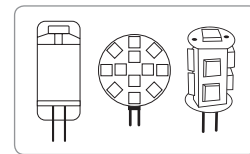

LED-eksempler

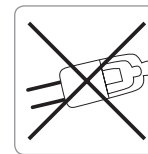

Bruk ikke halogenpærer

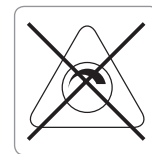

Kan ikke dimmes

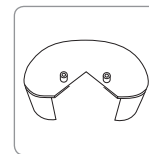

Demonter plastdekselet ved utskifting av lyskilde

## MONTERINGSVEILEDNING

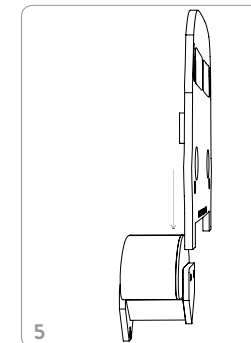
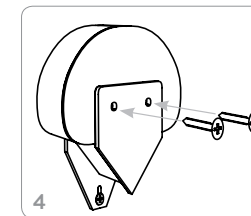
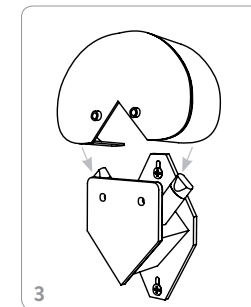
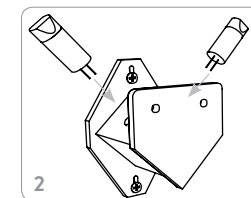
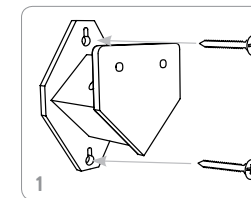

1. Sett lampeholderen på veggen og fest den med to av de medfølgende skruene

2. Sett inn to LED-lyskilder

3. Sett plastdekselet over LED-lyskildene

4. Fest plastdekselet til lampeholderen med to av de medfølgende skruene

5. Trekk lampefronten ned over forreste del av lampeholderen. Koble LED-driveren til lampen og deretter til strømforsyningen

## UPPLÝSINGAR - IS

Lampann skal einungis nota þegar búið er að festa hann við vegginn. Hann skal setja upp samkvæmt landsbundnum reglugerðum varðandi uppsetningu. Öll önnur notkun er talin vera í ósamræmi við leiðbeiningar. Tryggið að gildi vörunnar uppfylli kröfur afgjafans áður en ljósið er sett upp. Ráðlagt er að festa snúruna við vegginn þar sem hætta er á að lausar snúrur vefjist um háls barna og ungabarna og valdi öndunarteppu.

## GÖGN

### Viður

Krossviður með framhlið úr eikarspón eða málaða framhlið

### Plastskermur

Opal pólýkarbonat (opal Lexan 940)

### Tenging

AC 220-240V-50/60 Hz með LED millistykki

### IP-kóði

IP20

### Ljósgefjafar

LED einungis  
Rafafli hárm. 2 x 3W  
Rafspenna: 12V  
Innstunga lampa: G4

### LED millistykki

AC 220-240V-50/60 Hz  
Straumbreytir 12völt,  
12W aft: 1 Amp.

### Orkunotkun

millistykki  
í reiðuhám: 0,0W

## LJÓSGJAFAR

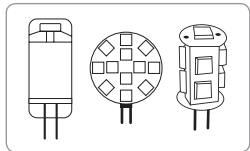

Dæmi um LED

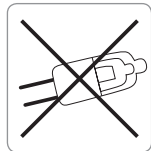

Án halógen ljósgjafa

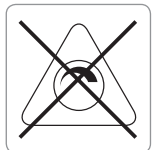

Án dimmara

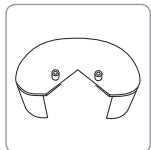

Takið plastskerminn í sundur þegar skipt er um ljósgjafa

## UPPLÝSINGAR UM UPPSETNINGU

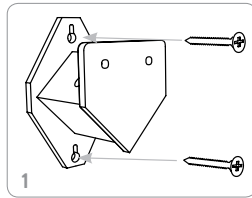

1

1. Setjið innstungu lampans á vegginn og festið hana með tveimur skrúfum

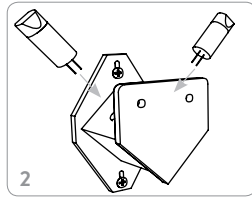

2

2. Setjið tvo LED ljósgjafa í lampann

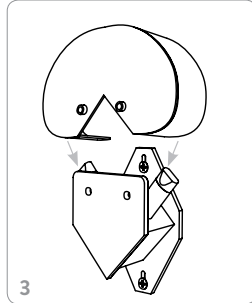

3

3. Takið plastskerminn og setjið hann yfir LED ljósgjafana

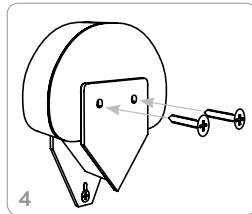

4

4. Festið plastskerminn við lampainnstunguna með tveimur skrúfum

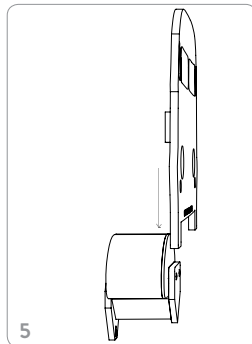

5

5. Rennið framhluta lampans niður á framhluta lampainnstungunnar. Tengjið LED millistykkið við lampann og við afgjafann

## TIETOA - FI

Valaisin on tarkoitettu ainoastaan kiinnitettäväksi seinään, ja se tulee asentaa paikallisia määräyksiä noudattaen. Muunlainen käyttö katsotaan käyttöohjeen vastaiseksi käytöksi. Ennen valaisimen asennusta on varmistettava, että valaisimen arvokilvessä ilmoitetut tiedot vastaavat syöttötehoa. Suosittelemme johdon kiinnittämistä seinään, sillä irrallinen johto saattaa aiheuttaa kuristumisvaaran vauvoille ja pienille lapsille.

## TIEDOT

### Puu

Vaneri, etuosa savutammiviilua tai maalattu

### Muovikuori

Läpikuultava polykarbonaatti (läpikuultava Lexan 940)

### Liitäntä

AC 220-240V-50/60 Hz ja LED-virtalähde

### IP-luokka:

IP20

### Valonlähteet:

Vain LED-lamput  
Wattiluku enintään 2 x 3 W  
Jännite: 12 V  
Lampun kanta: G4

### LED-virtalähde

AC 220-240V-50/60 Hz  
DC 12V, 12W virta: 1 A

### Virrankulutus

valmiustilassa:  
Teho: 0,0W

## VALONLÄHTEET

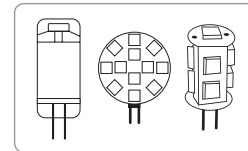

Esimerkkejä LED-lampuista

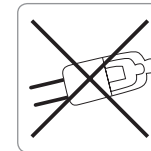

Ei halogeeni-lamppuja

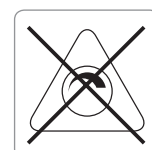

Ei himmennettävä

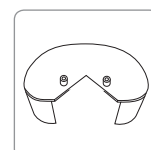

Irrota muovikuori lampunvaihdon ajaksi

## ASENNUSOHJEET

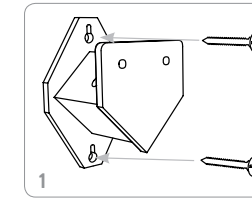

1

1. Kiinnitä valaisimen pohjaosa seinään mukana tulevilla ruuveilla (2 kpl)

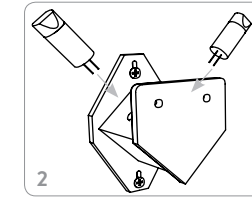

2

2. Kiinnitä LED-lamput paikoilleen (2 kpl)

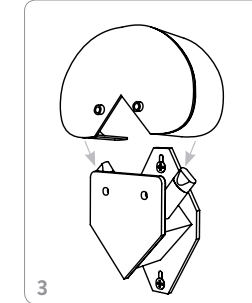

3

3. Pane muovikuori LED-lampujen päälle

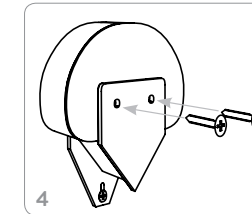

4

4. Kiinnitä muovikuori valaisimen pohjaosaan mukana tulevilla ruuveilla (2 kpl)

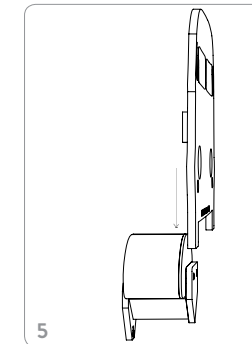

5

5. Liu'uta valaisimen etuosa pohjaosan päälle. Kytke LED-virtalähde valaisimeen ja pistorasiaan

## HINWEISE - DE

Die Lampe ist ausschließlich zur Wandmontage vorgesehen und muss entsprechend den nationalen Installationsvorschriften installiert werden. Jegliche andere Nutzung wird als nicht den Anweisungen entsprechend betrachtet. Vergewissern Sie sich, dass die Betriebsleistung des Produkts der Einspeiseleistung entspricht, bevor Sie die Leuchte installieren. Wir empfehlen, das Kabel an der Wand zu befestigen, da lose Kabel ein Strangulierungsrisiko für Säuglinge und Kleinkinder darstellen können.

## TECHNISCHE DATEN

### Holz

Sperrholz mit Front in Raucheichenfurnier oder Farbe

### Kunststoffabdeckung

Opal-Polycarbonat (Opal Lexan 940)

### Anschluss

220-240V Wechselspannung~50/60 Hz mit LED-Treiber

### IP-Code

IP20

### Leuchtmittel

Ausschließlich LED  
Wattleistung: max. 2 x 3W

Spannung: 12V  
Lampensockel: G4

### LED-Treiber

220-240V Wechselspannung~50/60 Hz  
23Volt Gleichspannung,  
12Watt, Stromstärke:  
1 Ampere

### Verbrauch des Treibers im Standby-Betrieb:

Effekt: 0,0W

## LEUCHTMITTEL

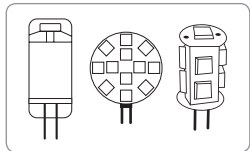

Beispiele für LEDs

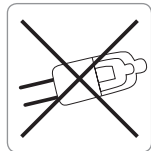

Keine Halogen-Leuchtmittel

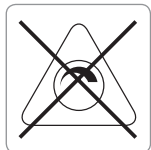

Nicht dimmbar

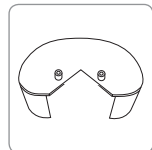

Zum Austauschen der Leuchtmittel die Kunststoffabdeckung abnehmen

## MONTAGEANWEISUNGEN

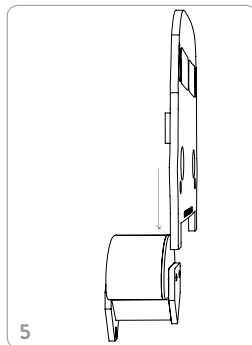
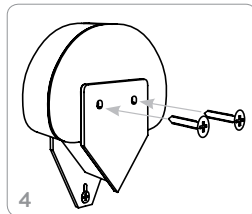
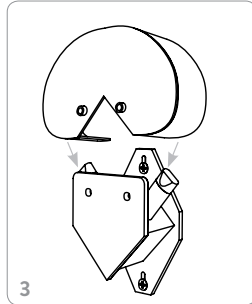
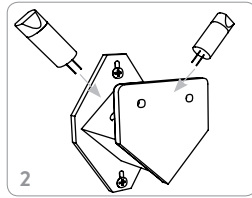
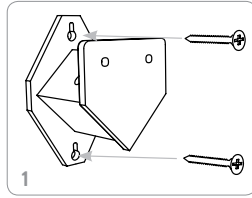

1. Platzieren Sie die Lampenfassung an der Wand und befestigen Sie sich mit zwei der beiliegenden Schrauben

2. Setzen Sie zwei LED-Leuchtmittel ein

3. Nehmen Sie die Kunststoffabdeckung und setzen Sie sie über den LED-Leuchtmitteln auf

4. Befestigen Sie die Kunststoffabdeckung mit zwei der beiliegenden Schrauben

5. Nehmen Sie die Lampenfront und schieben Sie sie von oben auf den vorderen Bereich der Lampenfassung. Schließen Sie den LED-Treiber an der Lampe und danach am Stromnetz an

## INFORMATIE - NL

De lamp is uitsluitend bedoeld voor verlichting bevestigd aan de muur en dient te worden geïnstalleerd in overeenstemming met de nationale installatiereggeving. Al het overige gebruik wordt gezien als niet in overeenstemming met de instructies. Controleer of de voltage van het product overeenkomt met de voltage van het stroomnet voordat u de armatuur installeert. We adviseren de draad aan de wand te bevestigen, omdat losse draden een risico op verwurging vormen voor baby's en kleine kinderen.

## GEGEVENS

### Hout

Multiplex met voorzijde in donker eiken fineer of geschilderde voorzijde

### Plastic kap

Ondoorzichtig polycarbonaat (Opal Lexan 940)

### Aansluiting

AC 220-240V~50/60 Hz met led-transformator

### IP-code

IP20

### Lampen

Uitsluitend led  
Wattage max. 2 x 3W  
Voltage: 12V  
Fitting: G4

### Led-transformator

AC 220-240V~50/60 Hz  
DC 12Volt, 12W stroom:  
1 Amp.

### Transformator stand-by verbruik:

Stroom 0,0W

## LAMPEN

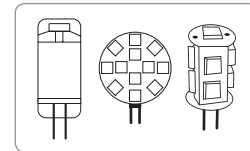

Voorbeelden led

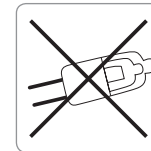

Geen halogeen lamp

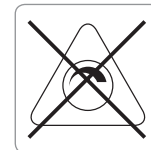

Dimmen niet mogelijk

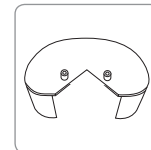

Verwijder de plastic kap van de lamp wanneer u lampen vervangt

## INSTALLATIEHANDLEIDING

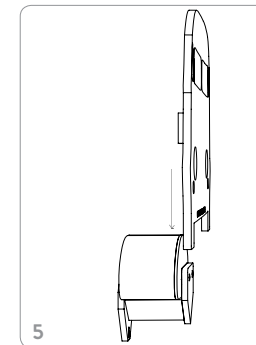
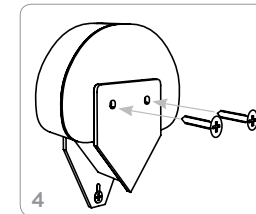
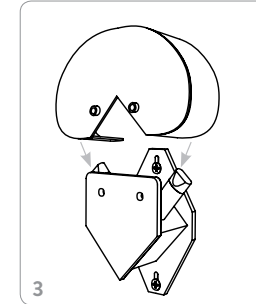
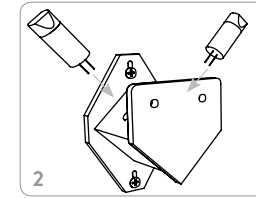
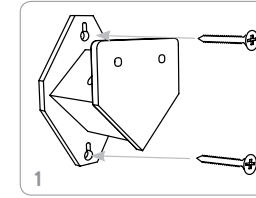

1. Plaats de fitting op de muur en maak hem vast met twee van de meegeleverde schroeven

2. Doe twee led-lampjes in de fitting

3. Neem de plastic kap en houd hem boven de led-lampjes

4. Plaats de plastic kap over de fitting en maak hem vast met twee van de meegeleverde schroeven

5. Neem de voorkant van de lamp en laat hem naar beneden glijden tot hij op de voorkant van de fitting rust. Sluit de led-transformator aan op de lamp en vervolgens op het stroomnet

## DESCRIPTION - FR

La lampe est exclusivement destinée à l'éclairage en étant fixée au mur, et doit être installée en respectant la réglementation nationale relative aux installations de ce type. Tout autre usage sera considéré comme non conforme aux instructions. Vérifiez que les valeurs nominales électriques du produit correspondent à celles de l'alimentation électrique secteur avant d'installer le luminaire. Nous recommandons de fixer le câble au mur, car les câbles non attachés peuvent constituer un risque d'étranglement pour les bébés et les petits enfants.

## DONNÉES

### Bois

Contreplaqué avec façade plaquée chêne fumé ou peint

### Couvercle en plastique

Polycarbonate opale (Lexan 940 opale)

### Raccord au secteur

220-240VCA-50/60 Hz avec alimentation pour LED

**Indice de protection**  
IP20

### Sources de lumière

LED uniquement  
Puissance max. 2 x 3W  
Tension: 12V  
Douille de lampe: G4

### Alimentation pour LED

220-240VCA-50/60 Hz  
12VCC, puissance 12W, 1 A

### Consommation de l'alimentation en veille:

Puissance: 0,0W

## SOURCES DE LUMIÈRE

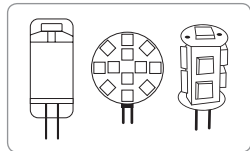

Ejemplos de LED

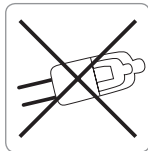

Ne convient pas aux sources de lumière halogènes

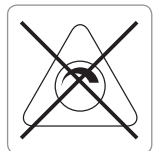

Non compatible avec les variateurs

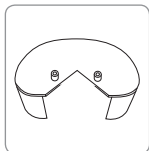

Démontez le couvercle en plastique pour changer les sources de lumière

## INSTRUCTIONS D'INSTALLATION

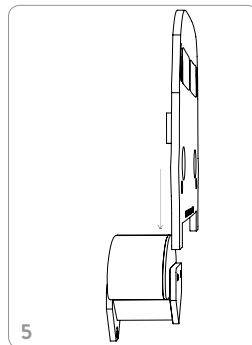
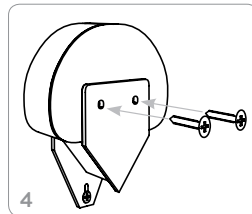
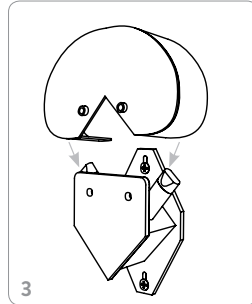
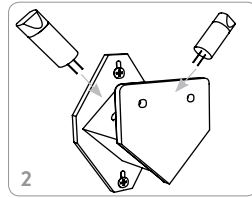
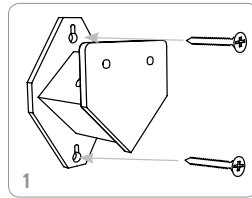

1. Placez la douille de lampe sur le mur et fixez-la avec deux des vis fournies

2. Insérez deux sources de lumière à LED

3. Prenez le couvercle en plastique et placez-le au-dessus des sources de lumière à LED

4. Fixez le couvercle en plastique à la douille de lampe avec deux des vis fournies

5. Prenez la façade de la lampe et faites-la glisser vers le bas sur l'avant de la douille de lampe. Raccordez l'alimentation pour LED à la lampe puis à la prise secteur

## INFORMACIÓN - ES

Esta lámpara se utiliza exclusivamente con sistemas de iluminación instalados en la pared; debe instalarse de acuerdo con los reglamentos nacionales de instalación. Cualquier otro uso que se le dé se considerará no conforme con las instrucciones. Antes de instalar la luminaria, verifique que las clasificaciones del producto correspondan a las clasificaciones de la fuente de alimentación. Recomendamos sujetar el cable a la pared, ya que los cables sueltos pueden constituir un riesgo de estrangulación para los bebés y los niños pequeños.

## DATOS

### Madera

Madera contrachapada con una chapa de roble ahumado o pintura en la parte frontal

### Cubierta de plástico

Polycarbonato opal (opal Lexan 940)

### Conexión

CA 220-240V~50/60 Hz con controlador de LED

**Código IP**  
IP20

### Fuentes de luz

Solo LED  
Potencia máxima: 2 x 3 vatios  
Tensión: 12 voltios  
Portalámpara: G4

**Controlador de LED**  
CA 220-240V~50/60 Hz  
CC 12 voltios, 12 vatios de potencia: 1 amperio

**Consumo del controlador en reposo**  
Potencia: 0,0 vatios

## FUENTES DE LUZ

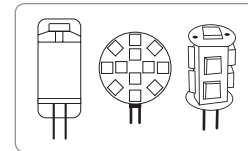

Ejemplos de LED

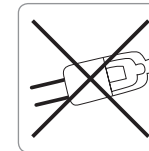

Sin fuente de luz halógena



No regulable

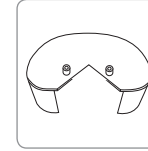

Cuando reemplace las fuentes de luz, retire la cubierta de plástico

## INSTRUCCIONES PARA EL MONTAJE

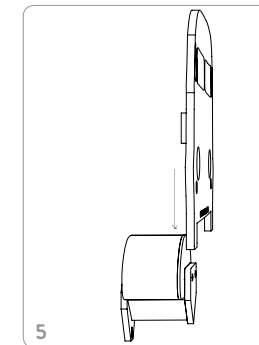
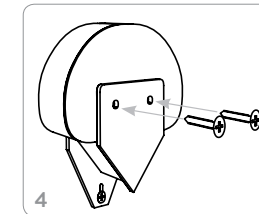
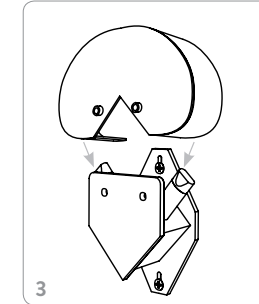
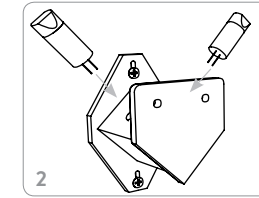
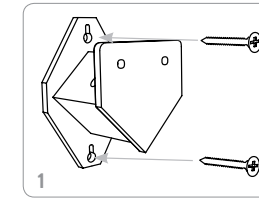

1. Coloque el portalámparas en la pared y asegúrelo con los dos tornillos incluidos

2. Coloque dos fuentes de luz LED

3. Retire la cubierta de plástico y colóquela sobre las fuentes de luz LED

4. Ajuste la cubierta de plástico en el portalámparas con dos de los tornillos incluidos

5. Tome la parte frontal de la lámpara y deslícela hacia abajo por la parte frontal del portalámparas. Conecte el controlador de LED a la lámpara y luego a la fuente de alimentación

## INFORMAÇÃO - PT

O candeeiro visa ser utilizado exclusivamente para iluminação de parede e tem de ser instalado de acordo com a legislação nacional de instalação. Qualquer outro uso é considerado como não estando de acordo com as instruções. Verificar se as classificações do produto cumprem os índices de electricidade antes de instalar a luminária. Recomendamos que prenda o fio à parede, pois os fios soltos podem provocar risco de estrangulamento para bebés e crianças pequenas.

## DADOS

### Madeira

Compensado na frente em verniz ou tinta de carvalho fumado

### Cobertura Plástica

Policarbonato Opala (Lexan 940 Opala)

### Ligação

AC 220-240V~50/60 Hz com controlador LED

### Código IP

IP20

### Fontes de Luz

Apenas LED  
Potência máx. 2 x 3W  
Voltagem: 12V  
Casquilho: G4

### Controlador LED

AC 220-240V ~ 50/60 Hz  
DC 12Volt, 12W  
potência: 1 Amp.

### Em Pausa do

**Controlador Consumo:**  
Potência: 0,0W

## FONTES DE LUZ

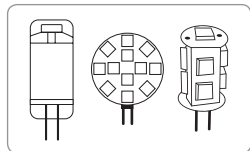

Exemplos LED

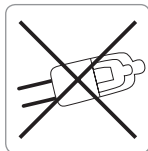

Sem fonte de luz de halogénio

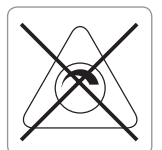

Não regulável

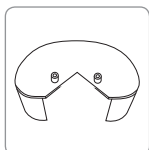

Cobertura de plástico desmontável quando substituir fontes de luz

## ISTRUÇÕES DE MONTAGEM

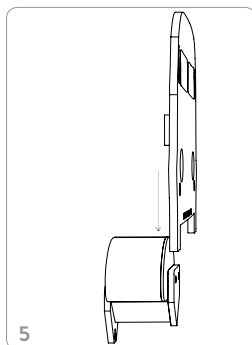
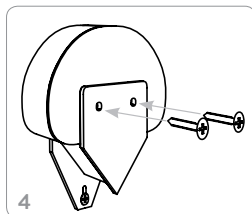
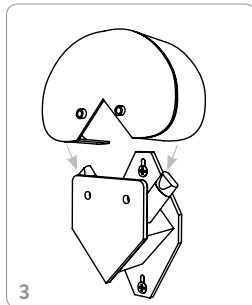
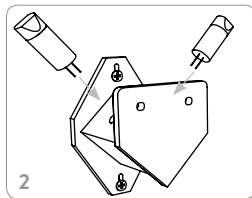
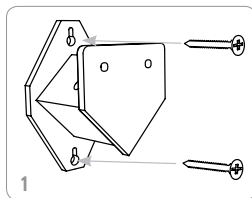

1. Coloque o casquilho na parede e prenda-o com dois dos parafusos incluídos

2. Coloque as duas fontes de luz LED

3. Pegue na cobertura de plástico e coloque-a sobre as fontes de luz LED

4. Aperte a cobertura ao casquilho com dois dos parafusos incluídos

5. Pegue na parte da frente do candeeiro e deslize-a na área frontal do casquilho. Ligue o Controlador LED ao candeeiro e depois à electricidade

## INFORMAZIONI - IT

Questa lampada deve essere utilizzata esclusivamente per l'illuminazione a parete e deve essere installata secondo le norme di installazione nazionali. Qualsiasi altro utilizzo non ottempera alle istruzioni fornite. Prima di installare l'apparecchio, verificare che i valori nominali del prodotto rispettino i valori relativi all'alimentazione elettrica. Consigliamo di fissare il cavo alla parete, poiché i cavi liberi sono pericolosi per neonati e bambini, costituendo un rischio di strangolamento.

## CARATTERISTICHE

### Legno

Compensato con parte frontale impiallacciata rovere fumé o vernice

### Coperchio di plastica

Policarbonato opalino (opal Lexan 940)

### Contatto

CA 220-240V~50/60 Hz con driver LED

### Classe di protezione IP:

IP20

### Sorgenti luminose:

Esclusivamente LED  
Potenza elettrica max. 2 x 3W  
Voltaggio: 12V  
Porta lampada: G4

### Driver LED

CA 220-240V~50/60 Hz  
CC 12Volt, 12W  
potenza: 1 Amp.

### Driver in Stand by

consumo:  
Potenza: 0,0W

## SORGENTI LUMINOSE

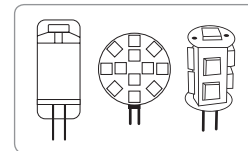

Esempi di LED

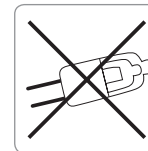

No sorgenti luminose alogene

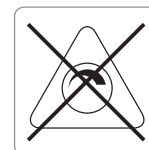

Privo di regolatore di luminosità

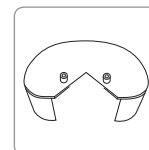

Smontare il coperchio di plastica quando si sostituiscono le sorgenti luminose

## ISTRUZIONI PER IL MONTAGGIO

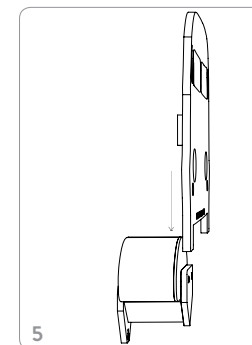
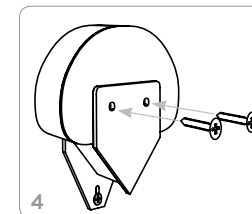
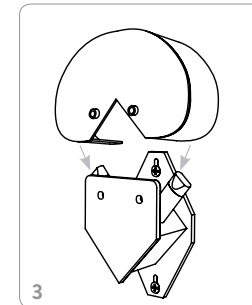
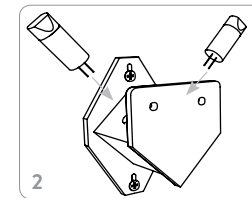
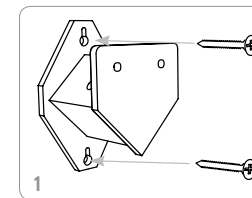

1. Posizionare il portalampada sulla parete e fissarlo con due delle viti incluse nella confezione

2. Inserire le due sorgenti luminose LED

3. Prendere il coperchio di plastica e posizionarlo sopra le sorgenti luminose LED

4. Fissare il coperchio di plastica al portalampada utilizzando due delle viti incluse nella confezione

5. Prendere la parte frontale della lampada e farla scorrere in basso sulla parte frontale del portalampada. Collegare il driver LED alla lampada e poi all'alimentazione elettrica



## INFORMACJA - PL

Lampa może być używana wyłącznie jako oświetlenie montowane na ścianie. Montaż należy wykonać zgodnie z obowiązującymi w tym zakresie krajowymi przepisami. Użytkowanie lampy w jakikolwiek inny sposób uznaje się za niezgodne z zaleceniami. Przed podłączeniem lampy upewnij się, że jej napięcie robocze jest zgodne z napięciem sieci. Zaleca się przymocowanie przewodu do ściany ze względu na ryzyko uduszenia się niemowląt i małych dzieci luźno wiszącym przewodem.

## DANE TECHNICZNE

### Drewno

Sklejka z przodu forniowana (dąb dymiony) lub malowana

### Plastikowa osłona

Poliwęglan opal (opal Lexan 940)

### Podłączenie

AC 220-240V~50/60 Hz z zasilaczem LED

### Kod IP

IP20

### Źródła światła

Tylko diody LED  
Moc maks. 2 x 3W  
Napięcie: 12V  
Gniazdo żarówek: G4

### Zasilacz LED

AC 220-240V~50/60 Hz  
DC 12V, moc 12W:  
1 Amp.

### Zużycie energii przez zasilacz w stanie oczekującym:

Moc: 0,0W

## ŹRÓDŁA ŚWIATŁA

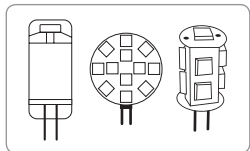

Przykładowe diody LED

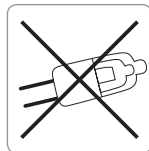

Nie stosować żarówek halogenowych

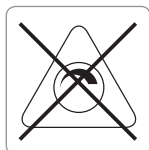

Nie stosować ze ściemniaczami

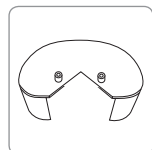

W celu wymiany źródeł światła zdemonstrować plastikową osłonę

## INSTRUKCJA MONTAŻU

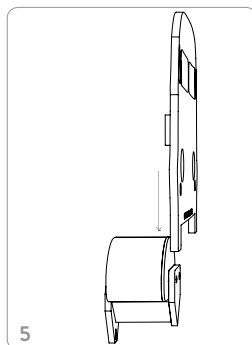
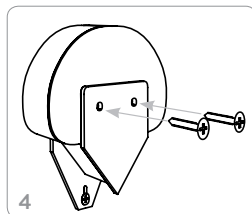
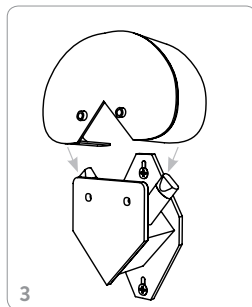
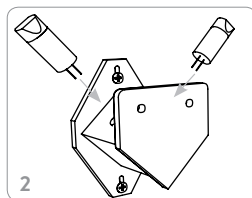
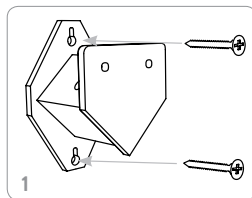

1. Umieścić korpus lampy na ścianie i zamocować go przy pomocy dwóch załączonych w zestawie śrub

2. Umieścić 2 źródła światła LED

3. Nałożyć plastikową osłonę powyżej źródeł światła LED

4. Przymocować plastikową osłonę do korpusu lampy przy pomocy dwóch załączonych w zestawie śrub

5. Wsunąć frontowy element lampy od góry wzdłuż przedniej powierzchni korpusu lampy. Podłączyć zasilacz LED do lampy, a następnie do sieci elektrycznej

## INFORMÁCIÓ - HU

A lámpa kizárólag falra szerelt világítótéstként használható, és a nemzeti szerelési szabályoknak megfelelően kell felszerelni. Minden más használat az utasításoktól eltérőnek minősül. A világítótéste felszerelése előtt ellenőrizze, hogy a termék teljesítménye megfelel-e a tápellátás teljesítményének. Javasoljuk, hogy a vezetéket rögzítse a falhoz, mivel a laza vezetékek a csecsemőkre és kisgyermekekre nézve fulladásveszélyt hordoznak.

## ADATOK

### Fa

Furnérlap füstölt tölgy vagy festett borítástú előlappal

### Műanyag burra

Opálos polikarbonát (opálos Lexan 940)

### Csatlakozás

AC 220-240V~50/60 Hz LED-vezérlővel

### IP kód:

IP20

### Fényforrások:

Kizárólag LED  
Elektromos teljesítmény max. 2 x 3 W  
Feszültség: 12 V  
Lámpa aljzat G4

### LED-vezérlő

AC 220-240V~50/60 Hz  
DC 12v, 12W  
áramerősség: 1 amper

### Vezérlő készenléti fogyasztása

Áram: 0,0 W

## FÉNYFORRÁSOK

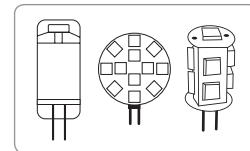

Példák LED-re

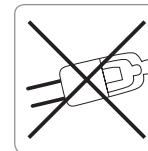

Nem halogén fényforrás

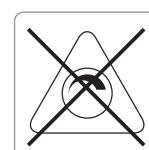

Nem szabályozható

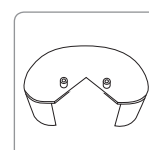

A fényforrások cseréjekor szerelje szét a műanyag burát

## FELSZERELÉSI UTASÍTÁSOK

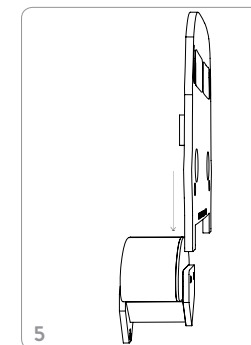
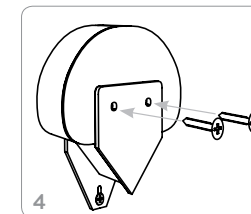
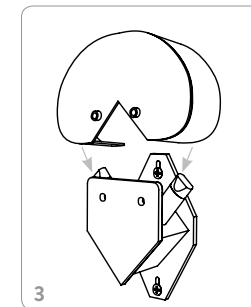
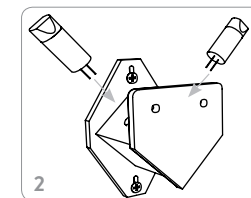
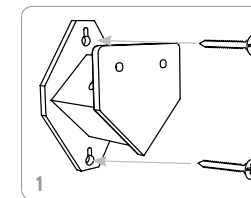

1. Helyezze a falra a lámpa aljzatot, és rögzítse a mellékelt csavarok közül kettővel

2. Helyezzen be két LED fényforrást

3. Vegye a műanyag burát, és helyezze a LED fényforrások fölé

4. Szorítsa rá a műanyag burát a lámpa aljzatra a mellékelt csavarok közül kettővel

5. Vegye a lámpa elejét, és csúsztassa le a lámpa aljzat elülső részén. Csatlakoztassa a LED-vezérlőt a lámpához, majd a tápellátáshoz

## INFORMACE - CZ

Svítilno je určeno výhradně pro montáž na stěnu. Při instalaci svítidla dodržujte platné národní normy. Jiné použití svítidla je považováno za porušení pokynů k použití. Před instalací svítidla se ujistěte, že parametry napájecí sítě odpovídají napájecím parametrům svítidla. Doporučujeme připevnit napájecí kabel ke stěně, protože u volně pověšených kabelů hrozí kojecům a malým dětem riziko uškrcení.

## ÚDAJE

### Dřevo

Dřevotřísková s dýhou  
kouřového dubu či nátěr

### Plastový kryt

Opálově mléčný  
polykarbonát  
(opál Lexan 940)

### Napájení

AC 220-240V~50/60 Hz  
s ovladačem LED

Stupeň vnitřního krytí  
IP20

### Zdroje světla

Pouze LED  
Příkon max. 2 x 3W  
Napětí: 12V  
Patice: G4

### Ovladač LED

AC 220-240V ~ 50/60 Hz  
DC 12 V, příkon  
12W: 1 A

### Spotřeba ovladače v pohotovostním režimu:

Příkon: 0,0W

## ZDROJE SVĚTLA

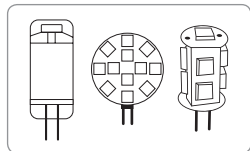

Příklady LED dostupných

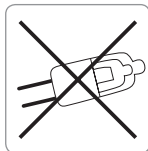

Bezhalogenový  
zdroj světla

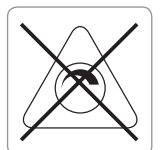

Nestmívatelný

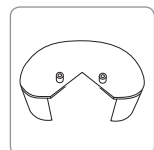

Při výměně diod  
odstraňte plastový  
kryt

## MONTÁŽNÍ NÁVOD

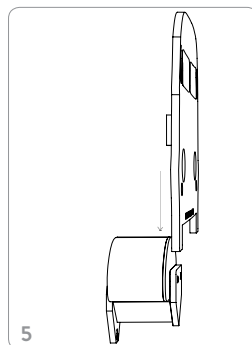
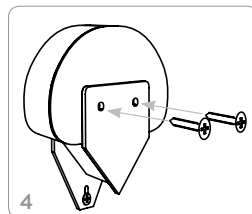
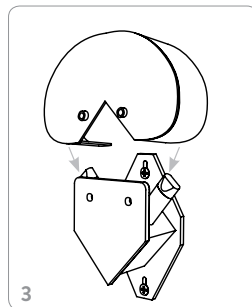
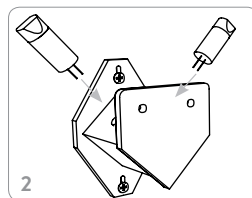
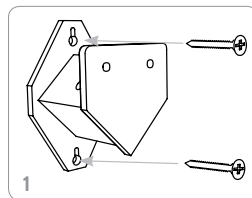

1. Umístěte konzolu s objímkami na stěnu a zajistěte ji dvěma příloženými šrouby

2. Vložte 2 diody

3. Uchopte plastový kryt a umístěte jej na diody

4. Připevněte plastový kryt ke konzole pomocí dvou příložených šroubů

5. Uchopte čelní kus svítidla a nasuňte jej shora dolů na konzolu v přední části svítidla. Připojte ke svítidlu LED ovladač, poté zapojte svítidlo do napájecí sítě

## INFORMACIJE - SI

Svetilka, montirana na steno, se uporablja izključno za razsvetljavo in jo je potrebno namestiti v skladu z nacionalnimi predpisi za montažo. Vsaka druga uporaba se šteje, da ni v skladu z navodili. Pred namestitvijo svetilke se prepričajte, da je oznaka izdelka v skladu z oznako napajanja. Priporočamo, da žico pritrdite na zid, saj lahko ohlapne žice povzročijo nevarnost zadušitve za dojenčke in majhne otroke.

## PODATKI

### Les

Vežan les s sprednjim delom iz prekanjenega hrastovega furnirja ali barvanim sprednjim delom

### Plastični pokrov

Opalni polikarbonat (opal Lexan 940)

### Povezava

AC 220-240V~50/60 Hz z LED gonilnikom

### IP koda

IP20

### Viri svetlobe

Samo LED  
Poraba v vatih največ 2 x 3W  
Napetost: 12V  
Vznožek žarnice: G4

### LED gonilnik:

AC 220-240V~50/60 Hz  
DC 12 voltov, 12W  
napajanje: 1 amp.

### Čas pripravljenosti gonilnika poraba

Moč: 0,0 W

## VIRI SVETLOBE

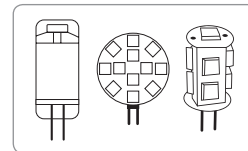

Primeri LED

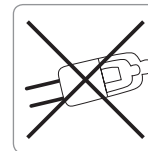

Brez halogenskega  
vira svetlobe

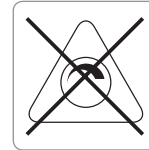

Brez možnosti  
zatemnitve

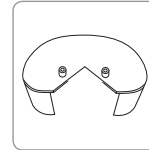

Ob zamenjavi  
virov svetlobe  
odstranite  
plastični okvir

## NAVODILA ZA MONTAŽO

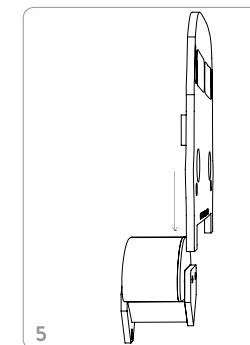
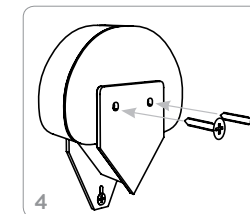
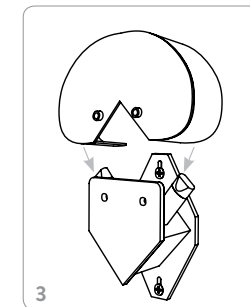
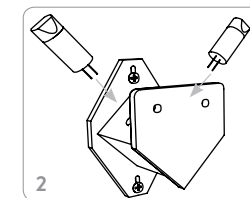
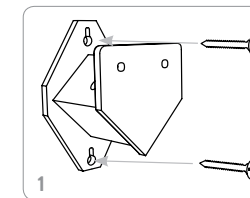

1. Vznožek žarnice namestite na zid in ga zavarujte z dvema priloženima vijakoma

2. Vstavite dve LED žarnici

3. Plastični okvir namestite nad LED žarnici

4. Plastični okvir na vznožek žarnice pritrdite z dvema priloženima vijakoma

5. Vzemite sprednji del svetilke in ga potisnite navzdol na sprednji strani vznožka žarnice. LED gonilnik priključite na svetilko in nato na napajanje

## TEAVE - EE

Lamp on mõeldud spetsiaalselt seinale kinnitamiseks ning tuleb paigaldada vastavalt kohalikele paigalduseeskirjadele. Suunistest erinevat kasutamist peetakse mitteotstarbekohaseks. Enne paigaldamist veenduge, et toote andmed vastavad soovitud andmetele. Soovitame kinnitada juhtme seinla külge, et vältida lahtistest juhtmetest tingitud lämbumisohtu imikutel ja väikelastel.

## ANDMED

### Puit

Vineerist esiküljel on suitsutatud tamm või värvitud

### Plastkate

Opaal polikarbonaat (opaal Lexan 940)

### Ühendus

Vahelduvvool 220-240V ~50/60 Hz koos LED-juhiga

### IP kood

IP20

### Valgusallikad

Ainult LED  
Max võimsus: 2 x 3W  
Pinge: 12V  
Lambipesa: G4

### LED-juht:

Vahelduvvool, 220-240V ~50/60 Hz  
alalisvool 12V, 12W  
voolutugevus: 1 A

### Juhi voolutarve ooterežiimis:

Voolutarve: 0,0W

## VALGUSALLIKAD

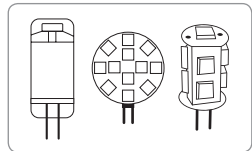

LED-ide näited

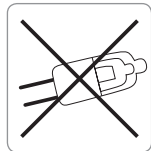

Halogenlampe ei tohi kasutada

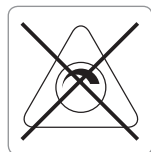

Reguleeritavaid lampe ei tohi kasutada

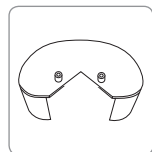

Valgusallikate vahetamisel eemaldage plastkate

## PAIGALDUSSUUNISED

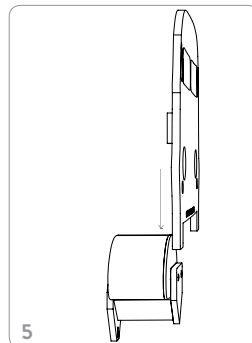
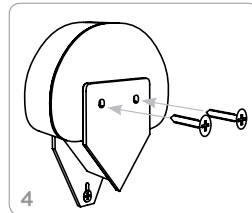
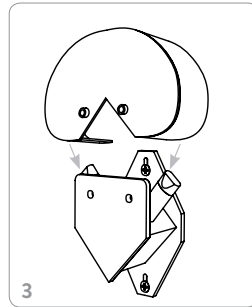
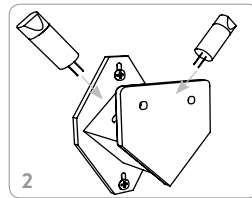
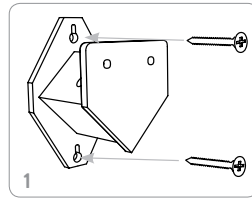

1. Asetage lambipesa seinale ja kinnitage kahe kaasasoleva kruviga

2. Paigaldage kaks LED-valgusallikat

3. Asetage plastkate LED-valgusallikate kohale

4. Kinnitage plastkate kahe kaasasoleva kruvi abil lambipesa külge

5. Kinnitage lambi esiküljel lambipesa eesmisele osale, lükates seda alla. Ühendage LED-juht lambiga ning seejärel vooluvõrku

## INFORMĀCIJA - LV

Šī lampa paredzēta tikai apgaismošanai, nostiprināma pie sienas, un tā ir jāpieliek saskaņā ar vietējām elektroierīču uzstādīšanas normām. Jebkāda cita veida lietošana tiek uzskatīta par neatbilstošu instrukcijai. Pirms gaismekļa pielikšanas, pārbaudiet, vai produkta spiedums atbilst vietējā elektroenerģijas tīkla spriegumam. Iesakām nostiprināt vadu pie sienas, jo brīvi krītoši vadi var izraisīt nožņaugšanās risku zidaiņiem un maziem bērniem.

## DATI

### Koks

Saplāksnis priekšpusē dūmakainā krāsotā vai lakota ozolkoka tonī

### Plastmasas pārsegs

Opāls polikarbonāts (opaal Lexan 940)

### Savienojums

AC 220-240V~50/60 Hz ar LED vadību

### IP kods

IP20

### Spuldzes

Tikai LED  
Jauda vatos maks. 2 x 3W  
Spriegums: 12V  
Spuldzes ligzda: G4

### LED vadība

AC 220-240V~50/60 Hz  
DC 12Volti, 12W jauda:  
1 Amp.

### Patēriņš izslēgtā veidā:

Jauda: 0,0W

## SPULDZES

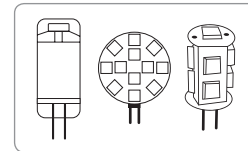

LED paraugi

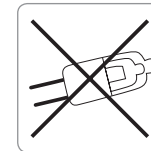

Neizmanto halogēna gaismas avotus

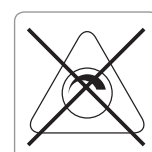

Bez apgaismojuma spilgtuma regulēšanas

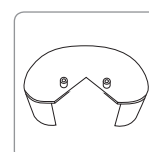

Pirms gaismas avotu nomaiņas, noņemiet plastmasas pārsegu

## MONTĀŽAS INSTRUKCIJA

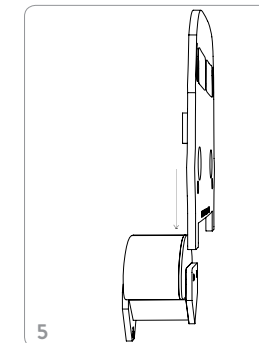
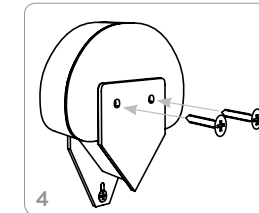
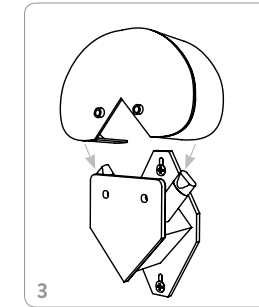
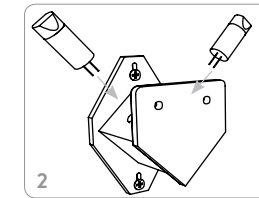
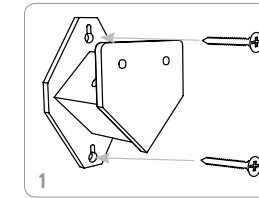

1. Novietojiet lampas pamatu uz sienas un pieskrūvējiet to ar divām komplektā esošajām skrūvēm.

2. Ievietojiet divas LED spuldzes.

3. Uzlieciet plastmasas pārsegu uz LED spuldzēm.

4. Piestipriniet plastmasas pārsegu uz lampas pamatnes ar divām komplektā esošajām skrūvēm.

5. Paņemiet lampas priekšdaļu un pārbīdiet to pāri pamatnes priekšdaļai. Pieslēdziet LED vadu lampai un pēc tam strāvas padevei.

## INFORMACIJA - LT

Lempa naudojama tik ant sienos montuojamam apšvietimui ir turi būti montuojama laikantis šalyje taikomų montavimo nuostatų. Bet koks kitas naudojimas prieštarauja instrukcijoms. Prieš montuodami šviestuvą patikrinkite, ar gaminio parametrai atitinka tiekiamosrovės parametrus. Rekomenduojame laidą pritvirtinti prie sienos, nes dėl kabančių laidų kūdikiams ir mažiems vaikams kyla pavojus pasismaugti.

## DUOMENYS

### Mediena

Klijuota fanera su dūmintu ažuolu arba dažytu priekiu

### Plastikinis gaubtas

Opalo spalvos polikarbonatas (opal Lexan 940)

### Maitinimas

AC 220-240V~50/60 Hz su LED

### IP kodas

IP20

### Šviesos šaltiniai

Tik LED  
Galia vatais maks. 2 x 3W  
Įtampa: 12V  
Lempos lizdas: G4

### LED maitinimo blokas:

AC 220-240V~50/60 Hz  
12 voltų nuolatinė srovė (DC), 12W galia: 1 amp.

### Maitinimo bloko budėjimo režimas vartojimas

Galia: 0,0W

## ŠVIESOS ŠALTINIAI

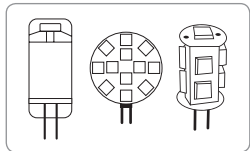

LED pavyzdžiai

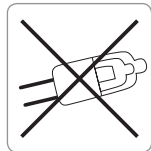

Netinka halogeniniai šviesos šaltiniai

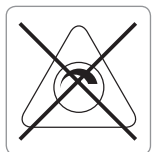

Nedimeriuojama

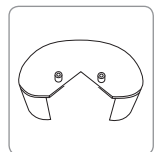

Keisdami šviesos šaltinį, išardykite plastikinį gaubtą

## MONTAVIMO INSTRUKCIJOS

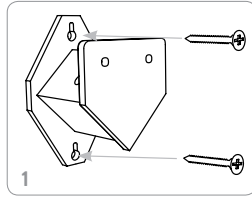

1. Lempos lizdą pritvirtinkite prie sienos dviem priedamais varžtais

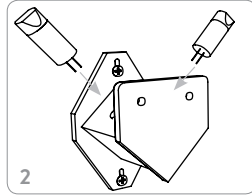

2. Įdėkite du LED šviesos šaltinius

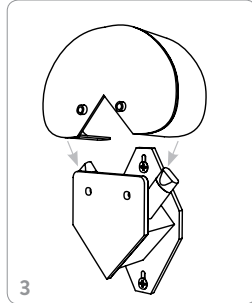

3. Paimkite plastikinį gaubtą ir uždėkite jį virš LED šviesos šaltinių

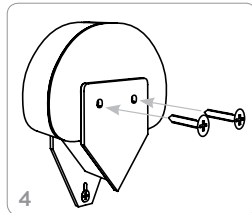

4. Plastikinį gaubtą pritvirtinkite prie lempo lizdo dviem priedamais varžtais

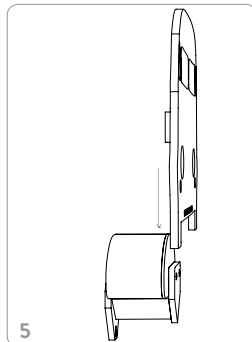

5. Suimkite lempo priekį ir paslinkite jį žemyn ant lempo lizdo priekinės dalies. Prijunkite LED maitinimo bloką prie lempo, o tada prie maitinimo tinklo

## PLĖROFORIES - EL

To φωτιστικό χρησιμοποιείται αποκλειστικά για φωτισμό τοποθετημένο στον τοίχο, και θα πρέπει να τοποθετείται σύμφωνα με τους εκάστοτε εγχώριους κανονισμούς εγκατάστασης. Για κάθε άλλη χρήση θα θεωρείται πως δεν τηρούνται οι οδηγίες. Πρωτό τοποθετήστε το φωτιστικό επαληθεύστε ότι οι προδιαγραφές του προϊόντος συμπίπτουν με τις ονομαστικές τιμές της παροχής ρεύματος. Συνιστούμε την πρόσδεση του καλωδίου στον τοίχο, καθώς τα ελεύθερα καλώδια μπορεί να προκαλέσουν κίνδυνο στραγγαλισμού σε βρέφη και νήπια.

## ΣΤΟΙΧΕΙΑ

### Εύλο

Κοντραπλάκε με πρόσφυση από καπλάμα καπνιστής βελανιδιάς ή βαφή

### Πλαστικό κάλυμμα

Λευκό ιριδιζόν πολυανθρακικό πλαστικό (λευκό ιριδιζόν λεξάν 940)

### Σύνδεση

AC 220-240V~50/60 Hz με οδηγό LED

### Κωδικός IP:

IP20

### Φωτεινές πηγές:

Μόνο LED  
Ένταση έως 2 x 3W  
Τάση: 12V  
Υποδοχή φωτιστικού: G4

### Οδηγός LED

AC 220-240V~50/60 Hz  
DC 12Volt, ισχύς 12W:  
1 amp.

### Κατανάλωση Οδηγού σε αναμονή

Ισχύς: 0,0W

## ΦΩΤΕΙΝΕΣ ΠΗΓΕΣ

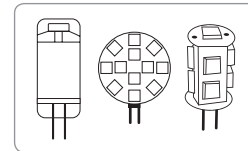

Υποδείγματα LED

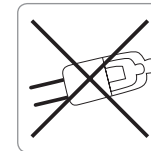

Φωτεινή πηγή χωρίς αλογόνο

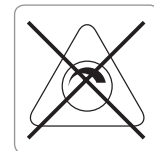

Χωρίς δυνατότητα μετρίασης φωτισμού

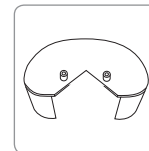

Όταν αντικαθιστάτε τις φωτεινές πηγές να αποσυνδέετε το πλαστικό κάλυμμα

## ΟΔΗΓΙΕΣ ΤΟΠΟΘΕΤΗΣΗΣ

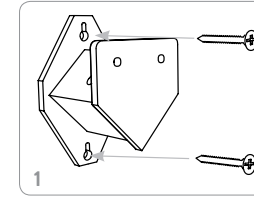

1. Τοποθετήστε την υποδοχή του φωτιστικού στον τοίχο και στερεώστε την με δύο από τις παρεχόμενες βίδες

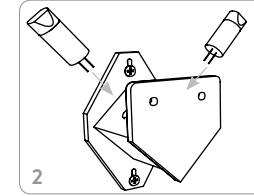

2. Τοποθετήστε δύο φωτεινές πηγές LED

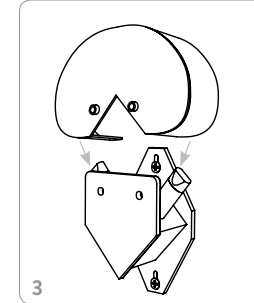

3. Πάρτε το πλαστικό κάλυμμα και τοποθετήστε το πάνω από τις φωτεινές πηγές LED

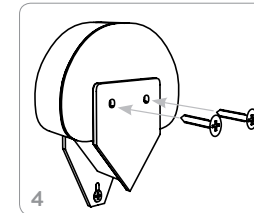

4. Στερεώστε το πλαστικό κάλυμμα στην υποδοχή του φωτιστικού με δύο από τις παρεχόμενες βίδες

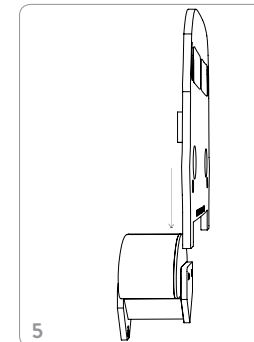

5. Πάρτε την πρόσφυση του φωτιστικού και σύρετέ την προς τα κάτω στην περιοχή της πρόσφυσης της υποδοχής του φωτιστικού. Συνδέστε τον οδηγό LED στο φωτιστικό και έπειτα στην παροχή ρεύματος